

# 205 Series Regulator

## Single Stage Typical Applications

### Chrome-Plated Forged Brass Body

### Four-Port Configuration

### 316L Stainless Steel Diaphragm

The 205 Series regulators are intended for secondary pressure control of non-corrosive, high purity or liquefied gases (up to grade 4.5) or as point of use pressure control in high purity gas distribution systems.

- Point of use laboratory systems
- Gas supply purging
- Liquefied hydrocarbon gas control
- Control of cryogenic gases
- Bulk gas distribution systems

### Advanced Features

- Chrome-plated forged brass body  
Economical high purity design
- High flow capacity  
Supply multiple user locations
- Pressure ranges 0-15 to 0-200 PSIG  
Broad range of applications
- 3000 PSIG inlet pressure rating  
Safe use with high pressure cylinders



205-3021 shown

## 200 Advantage

- *Capsule® seat*  
Increased serviceability and life
- *316L stainless steel diaphragm*  
No inboard diffusion
- *Forged body*  
Durable, long-lasting construction
- *Field-adjustable pressure limit*  
Safeguard downstream equipment
- *Large convoluted diaphragm*  
Smooth pressure changes
- *Standard relief valve*  
Diaphragm and gauge protection

## Materials

- Body*  
Chrome-plated forged brass
- Bonnet*  
Chrome-plated die cast zinc
- Seat*  
PTFE
- Filter*  
10 micron sintered bronze
- Diaphragm*  
316L stainless steel
- Internal Seals*  
PTFE

## Specifications

- Maximum Inlet Pressure*  
3000 PSIG (210 BAR)
- Temperature Range*  
-40°F to 140°F (-40°C to 60°C)
- Gauges*  
2½" diameter chrome-plated brass
- Ports*  
¼" FPT
- Helium Leak Integrity*  
1 x 10<sup>-8</sup> scc/sec
- Cv*  
0.2
- Weight (205-3031-TF4)*  
3.2 lbs. (1.44 kg)

# Flow Performance Curves

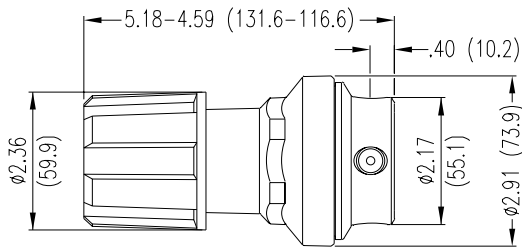
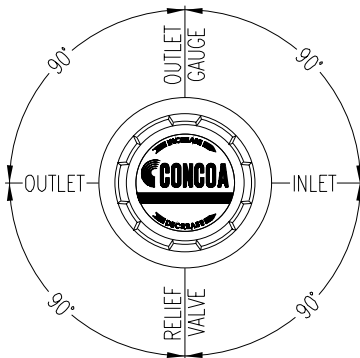
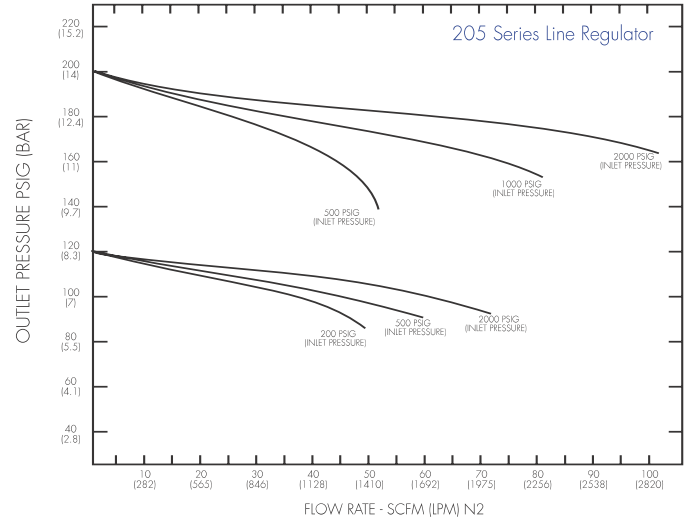
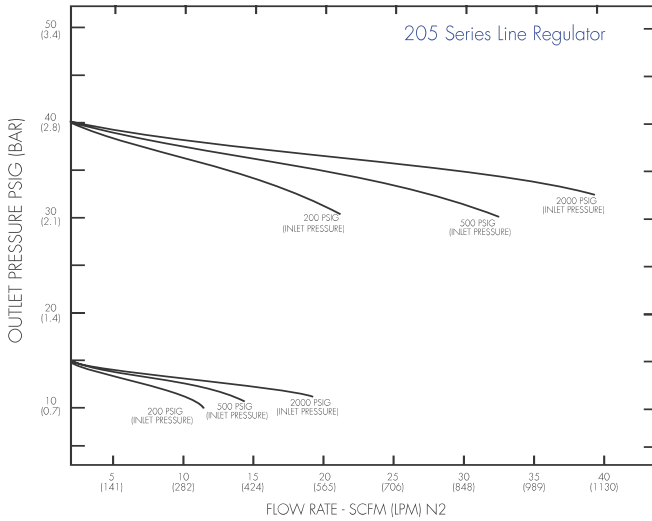

## Ordering Information *(For information about how to use this table please see page 4.)*

205-	A	B	C	D	-Inlet	Options	
<b>Series 205</b>	<b>Outlet Pressure</b> 1: 0-15 2: 0-40 3: 0-120 4: 0-200 5: 0-15	<b>Outlet Gauge</b> 0-30 PSIG 0-60 PSIG 0-200 PSIG 0-400 PSIG 0-30 PSIG with redline for acetylene use	<b>Inlet Gauge</b> 0: None	<b>Outlet Assemblies</b> 0: ¼" FPT Port 1: ¼" MPT 2: ¼" Tube Fitting 3: Diaphragm Valve ¼" Tube Fitting 4: Diaphragm Valve ¼" MPT 5: Needle Valve ¼" MPT 6: ⅛" Tube Fitting 7: ⅜" Tube Fitting 8: Diaphragm Valve ⅛" Tube Fitting 9: Diaphragm Valve ¼" FPT A: ⅜" BSP Right Hand Fitting B: Diaphragm Valve ⅜" Tube Fitting M: 6mm Tube Fitting S: Diaphragm Valve 6mm Tube Fitting	<b>Assembly/ Gauges</b> 0: Bare Body 1: Standard Assembly (PSIG/kPa Gauge) 2: Standard Assembly (BAR/PSIG Gauge)	<b>Inlet Connections</b> 000: ¼" FPT TF2: ⅛" Tube TF4: ¼" Tube TF6: ⅜" Tube M06: 6mm Tube  CGA DIN 477 BS 341 and others available	<b>Installed Options</b> M: Protocol Station